

TAM-00X

Token Acceptance Module

Feature

- High speed token acceptance
- Fast troubleshooting
- Token magazine design with high security
- Friendly maintenance and high reliability



TAM-00X bears a design concept of high security and reliability. The 2 token magazines function as the backup for each other to meet the application demand under large passenger flow volume. It features high accepting speed of tokens of multiple sizes. Secure lock and iButton provide realtime safeguard to token magazine. TAM-00X will definitely be the choice you never regret.



Metro



City Coach



BRT

TAM-00X

Token Acceptance Module

Performance

High Security and Reliability

- Adapt to tokens of multiple sizes with less token wear
- Electric shutter prevents double insertion and foreign insertion
- Intelligent token magazine status detection
- Electric tag (ibutton) supports token magazine tracking during operation
- Stainless steel token magazines feature high security and durability
- Invalid token rejection reduces allocation work

High Efficiency

- Token acceptance speed < 1s/token, meet the demand of fast transaction
- 2 token magazines with a large capacity of 1000tokens decrease replenishment frequency and operation cost

Friendly Maintenance

- Long service life and no consumable parts
- No electric part in token magazine reduces operation cost
- Visible inside of and multiple sensors within transport unit ensure fast token jam location and solution
- Flexible gap of transport unit ensures fast token jam solution without tools

Dimension(Unit: mm)

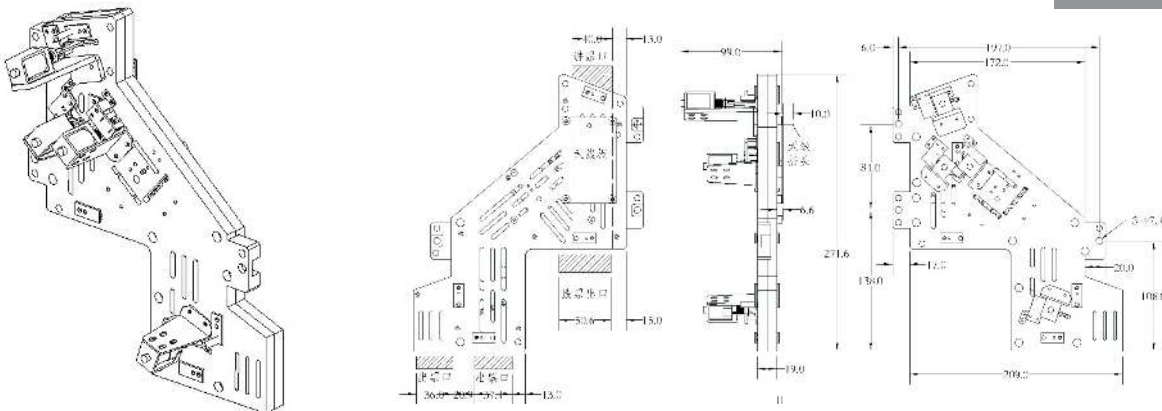

Note: In case the specifications be upgraded, you may as well contact with us to get the latest information.

Specification

Speed

- Acceptance $\leq 1s/token(0.5s$ for token reading)
- Rejection $\leq 0.4s/token$

Token Dimension

- Diameter: $30\pm 1mm$
- Thickness: $2.1\pm 0.2mm$ (or $3\pm 0.2mm$)

Capacity

- Magazine: 1000token $\times 2$

Power

- DC 24V $\pm 10\%$, 10W

Communication Interface

- RS-232

Weight

- 10kg(without testing frame)

Environment

- Working temperature: $-5^{\circ}C \sim 50^{\circ}C$
- Working humidity: 20% ~ 90% RH

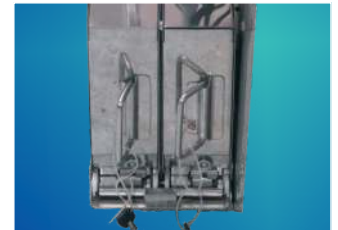

High reliability



Foreign prevent shutter

GRGBanking Equipment Co., Ltd.

Add: 9 Kelin Road, Science City, Luogang District, Guangzhou, China 510663
 Tel: +86 20 6287 9763
 Fax: +86 20 6287 9976
 Email: oem@grgbanking.com

Copyright by GRGBanking Equipment Co., Ltd.
 All rights reserved@201605

Specifications are subject to update without prior notice.
 Please consult GRGBanking or its representative for the latest information.